

Fichire thermocouple connecteur fil rapide miniature FMTC-CU-MQ type Cu

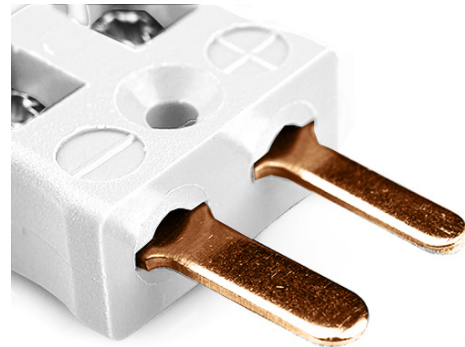
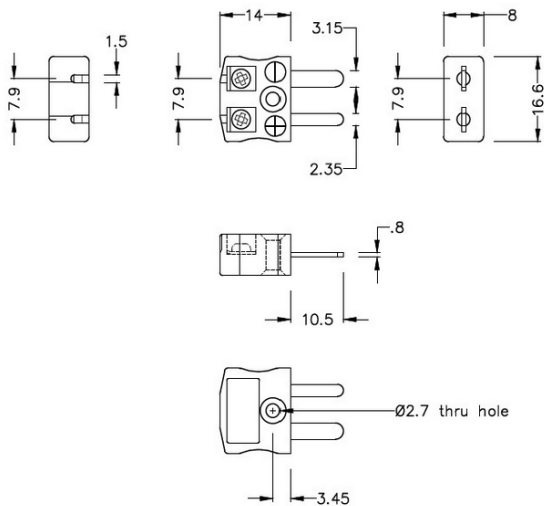

Miniature in-line Plug - Quick Wire
(dimensions in mm)

Labfacility are the UK's leading manufacturer of Temperature Sensors, Thermocouple Connectors and associated Temperature Instrumentation and stockings of Thermocouple Cables. The Company has been trading since 1971 and is ISO9001 accredited.

Connecteur miniature thermocouple Prise fil rapide FMTC-CU-MQ Type CU

Connecteur miniature avec broches de prise plates. Connexion facile par injection pour une limitation rapide. Il suffit de pousser le fil et de serrer la vis.

Caractéristiques techniques**Specifications**

Product Code	XE-1381-001
General Description	Easy jab-in connection for rapid termination.
Thermocouple Type	IEC, ANSI, JIS Type CU
Connector Type	Quick Wire Plug
Connector Size	Miniature
Colour	White
Max. Temperature	220°C
Pins	Flat Pins
+Positive Contact	Copper
-Negative Contact	Copper
Standards Met	BS EN 50212:1997. RoHS